

Location

Location Map

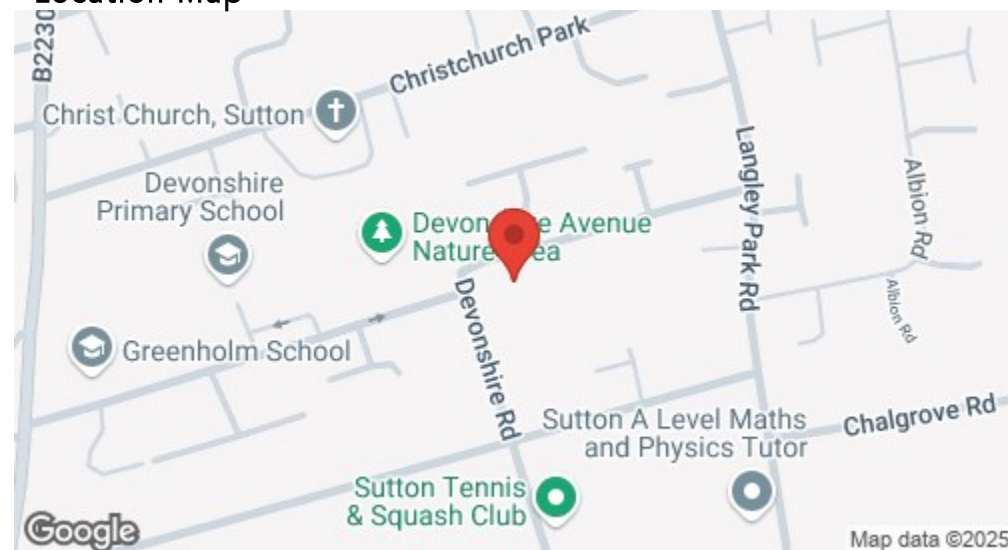

EPC Graph

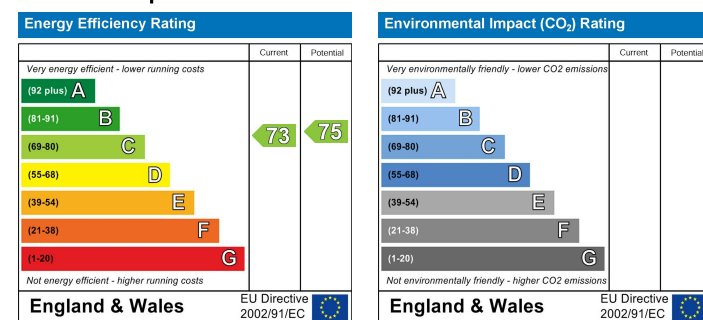

Important Note

Centro Residential Sales and Lettings limited have not tested any services, heating system, electrical system, appliances, fixtures and fittings, that may be included in this property and would advise interested parties to satisfy themselves as to their condition or investigating the presence of any deleterious materials.

Viewing: Strictly by appointment through:

CENTRO RESIDENTIAL SALES AND LETTINGS LIMITED

Tel: 020 8401 5000

E-mail: residential@centro.plc.uk

See a selection of our properties at www.centro.plc.uk

£1,300 Per Month - 1st March 2025

Devonshire Road, Sutton, SM2 5HH



Description

- Purpose Built
- Top Floor
- One Bedroom
- Open Plan Lounge
- Shower Room
- Residents Parking
- Visitors Parking
- EPC Rating C
- Council Tax Band C

Features

- Gas Central Heating
- Double Glazing
- Laminate Flooring

What you need to know

- Term: 12 months
- Rent: £1300pcm exclusive of bills
- Security deposit: £1500.00
- Council Tax Band C
- Energy Rating: C



Floor Plan

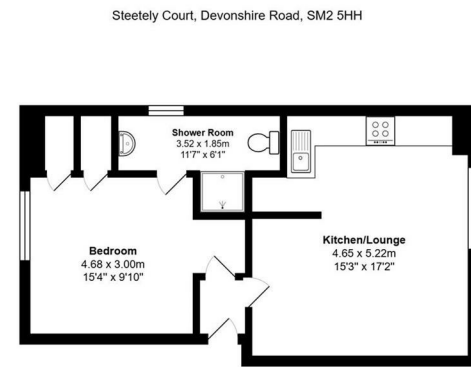

For illustration purposes only



All dimensions and measurements are approximate and for guidance only.

Just Centro's Opinion...

Nestled in the charming Devonshire Road, this delightful top floor apartment offers a perfect blend of comfort and convenience. Situated in a purpose-built development, the property is just a short stroll from Sutton Rail Station and the vibrant High Street, making it an ideal location for those who appreciate easy access to transport links and local amenities.

Upon entering, you will be greeted by an inviting open plan lounge and kitchen area, thoughtfully designed to create a spacious living and dining environment. The unique eaves of the apartment add a touch of character, enhancing the overall appeal of the space. The well-appointed kitchen provides ample room while the lounge area is perfect for relaxation or entertaining guests.

The apartment features one generously sized double bedroom, complete with built-in storage. This bedroom conveniently offers direct access to the modern shower room, providing both privacy and practicality.

For those with vehicles, the property boasts off-street parking for residents and visitors, alongside the added benefit of free on-road parking. This feature is particularly advantageous in a bustling area like Sutton.

Available from the start of March.

Additional Photos

